

Comfort-Cire® **Century**®
SE Series

Electric Gas Packaged Unit

RGP2460S1A
Parts List

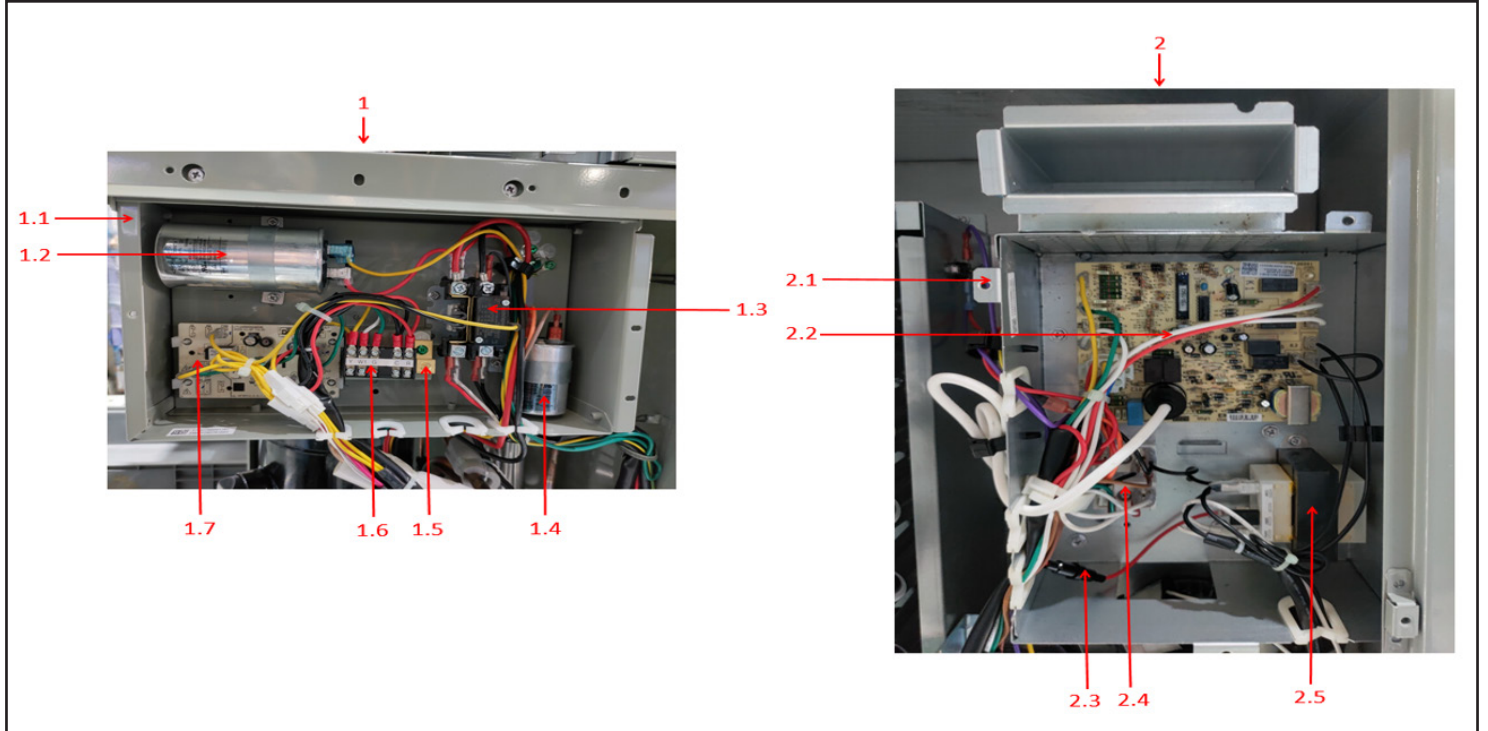
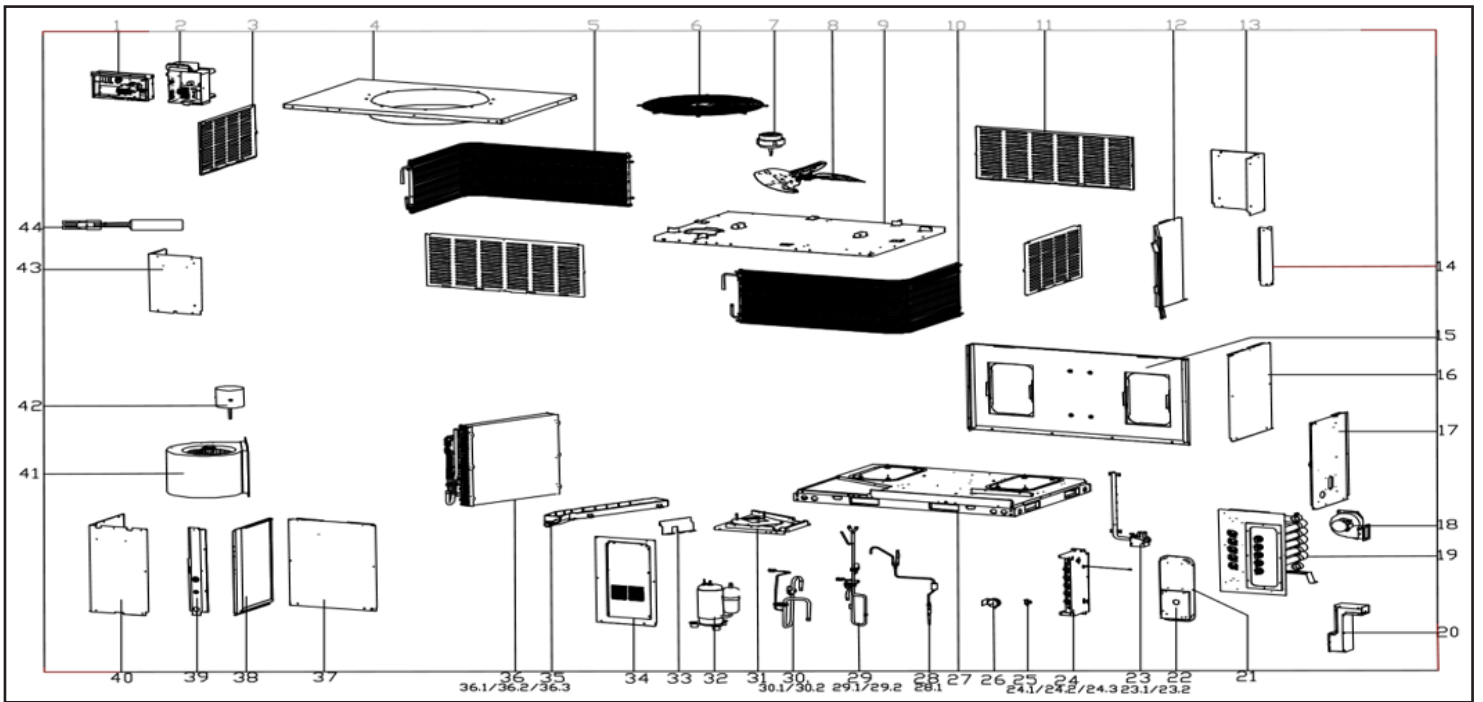

MARS®



Electric Gas Packaged Unit

RGP2460S1A Parts List

EX ID	Spare Parts Code	Part Name(EN)	Qty.	Recommend store spare parts
1	17227700A02472	E-part box assembly	1	
1.1	12227700A08021	Electronic control box body assembly	1	
1.2	17400103000135	Capacitor	1	
1.3	11203502000032	AC contactor	1	YES
1.4	17400103000152	Capacitor	1	
1.5	11201708000008	Wiring Terminal	1	
1.6	17400401001516	Wire joint	1	YES
1.7	17127700001166	Main control board assembly	1	YES
2	17227700001280	E-part box assembly	1	
2.1	12227700010298	Electronic control box body assembly	1	
2.2	17127600000648	Gas furnace, Main control board assembly	1	YES
2.3	17401203020513	Strong electric cable group	1	
2.4	17400401000208	terminal block,2P	2	
2.5	11203103000194	Linear Transformer	1	YES
3	12227700A07329	Protective plate assembly	2	
4	12227700A07342	Top cover welding assembly	1	
5	15827700001271	Condenser part	1	YES
6	12927700000341	protection net	1	
7	11002012001568	Single Phase Asynchronous Motor	1	YES
8	12200104000033	Axial fan	1	YES
9	12227700A08044	Top cover assembly	1	
10	15827700001273	Condenser part	1	YES
11	12227700A07323	Protective plate assembly	2	
12	12227700007504	Partition board assembly	1	
13	12227700A08040	Outer panel	1	
14	12227700008914	Column	2	
15	12227700A07338	Internal panel assembly	1	
16	12227700A07343	Internal panel assembly	1	
17	12227700A07374	Pole 5	1	
18	17400801008424	Exhaust fan ass'y	1	YES
19	15727700000051	Heat-exchanger ass'y	1	
20	12227700007444	Flue pipe welding assembly	1	

EX ID	Spare Parts Code	Part Name(EN)	Qty.	Recommend store spare parts
21	12227700007209	Gas-collecting hood	1	
22	12227700010340	Exhaust baffles	1	
23	15427700002352	Gas Components	1	
23.1	17427600001389	Gas Valve	1	YES
24	12227700010323	Burner ass'y	1	
24.1	17427600001429	Firing pin	1	YES
24.2	17400513000045	Thermostat	1	YES
24.3	11201006000010	Special sensor	1	YES
25	17400513001095	Thermostat	1	YES
26	11201008000027	Pressure sensor	1	YES
27	12227700A08009	Chassis part	1	
28	15427700002365	Throttle assembly	1	YES
29	15427700002370	Discharge pipe assembly B	1	
29.1	17400516000628	Pressure controller	1	YES
29.2	15500301000035	meter connector	1	YES
30	15427700002360	Suction pipe assembly	1	
30.1	17400516001088	Pressure switch	1	YES
31	12227700A07345	Compressor base assembly	1	
32	11103010016754	Fixed Speed Rotary Compressor	1	YES
33	12227700A08042	Waterproof plate	1	
34	12227700A08041	Outer panel assembly	1	
35	12127700000117	Drainage pan assembly	1	YES
36	15827700001229	Evaporator assembly	1	YES
37	12227700A07321	Internal panel assembly	1	
38	12227700A07340	Internal panel assembly	1	
39	12227700A08014	Column assembly	1	
40	12227700A07334	Panel	1	
41	12200102000175	Centrifugal fan	1	YES
42	11002015011928	Brushless DC Motor	1	YES
43	12227700A08016	Column assembly	1	
44	17400513000066	Discharge temp sensor	1	YES

Due to ongoing product improvements, specifications and dimensions are subject to change and correction without notice or incurring obligations. Determining the application and suitability for use of any product is the responsibility of the installer. Additionally, the installer is responsible for verifying dimensional data on the actual product prior to beginning any installation preparations.

Incentive and rebate programs have precise requirements as to product performance and certification. All products meet applicable regulations in effect on date of manufacture; however, certifications are not necessarily granted for the life of a product. Therefore, it is the responsibility of the applicant to determine whether a specific model qualifies for these incentive/rebate programs.



1900 Wellworth Ave., Jackson, MI 49203 • Ph. 517-787-2100 • www.marsdelivers.com

